



CORAIRE™

User Manual

Please read and follow the safety and operating instructions carefully. Keep this document for future reference. Improper use may cause product damage or personal injury.

Inflation and Pressure Control

- Recommended inflation pressure: 1.5-4 psi. Adjust firmness to preference.
- Do not exceed 4 psi during inflation. Overpressure can deform or damage the mattress. If overinflated, release air immediately.
- In cold or high-altitude areas, fully deflate before travel and reinflate at destination to prevent expansion damage. Longer inflation time in these conditions is normal.
- Air remaining in the Patented Air Coils Structure is normal.

Usage Environment and Safety Practices

- Keep away from heat sources. Do not use near flames, heaters, or while smoking. Heat damage is not repairable or covered under warranty.
- Do not jump, walk, or stand on the mattress to avoid injury or damage.
- For indoor and outdoor use only. Not for water use — not a life-saving device, floatation aid, or water toy.
- Not suitable for long-term bedridden patients; use a medical-grade mattress if needed.

! CAUTION



- To prevent suffocation or death, do not use this product for children under 3 years old.
- Keep at least 30 cm (12 in) from walls or objects to avoid trapping. Children and people with limited mobility should use only under supervision.



| INFLATION STEPS |

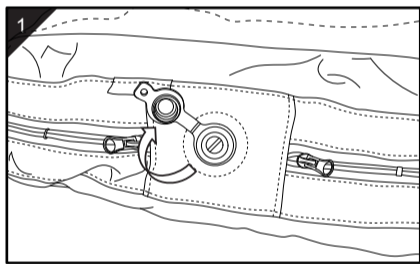

Open the plastic cap of one air valve.

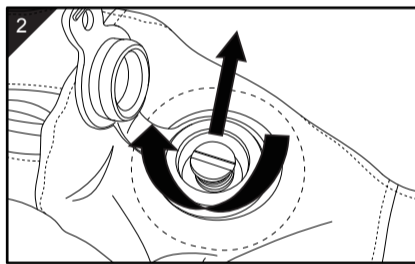

Press the red button inward and rotate it until the red button pops up. This indicates that the valve is in inflation mode.

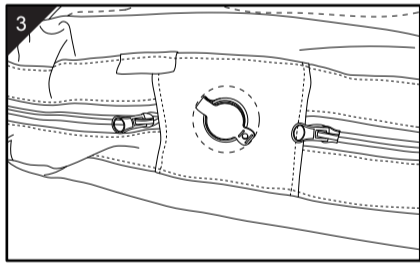

Close the plastic cap of the air valve.

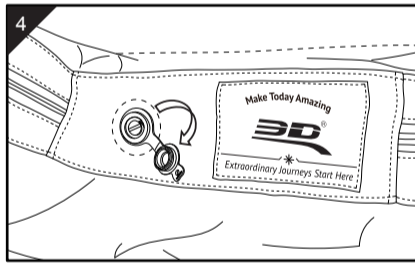

Open the plastic cap of the other air valve.

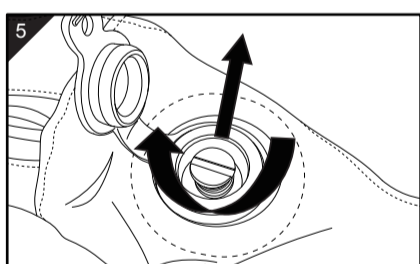

Confirm that the red button is in the raised position, indicating inflation mode. If not, repeat the procedure described in Step 2.

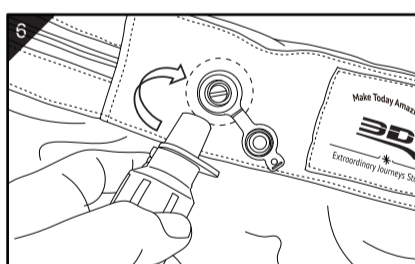

Attach the appropriate nozzle size to the inflation device.

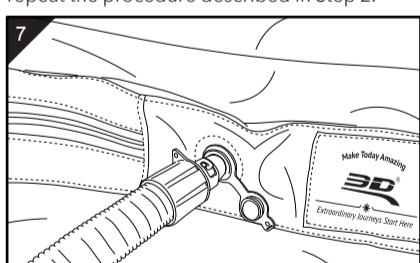

Insert the nozzle into the valve opening and begin inflating.



Once inflation is complete, securely close the plastic cap of the valve.

| DEFLATION STEPS |

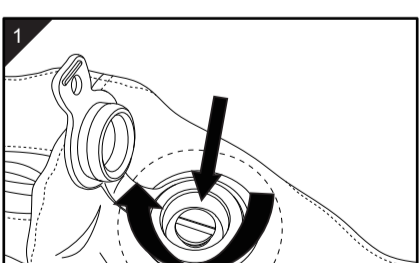

Open the plastic caps on both air valves. Press the red button inward and rotate it until it retracts, indicating the deflation mode.

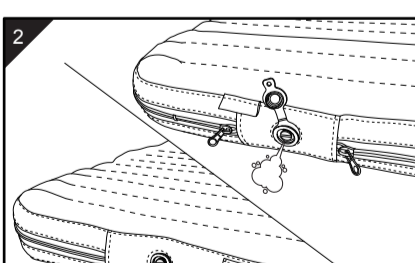

Ensure that the red buttons on both valves remain the pressed inward during the entire deflation process.

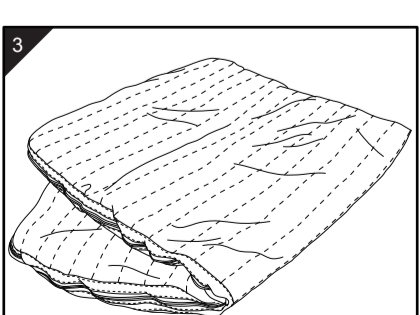

Fold the mattress in half.

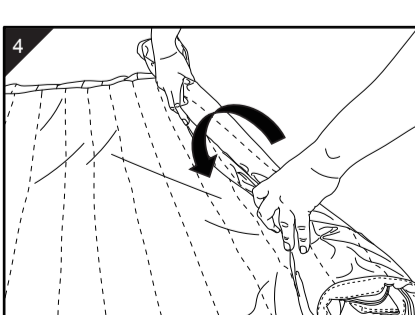

Starting from the folded center, roll the mattress toward both ends to expel the remaining air through the valves.